

Libro 350 Dual Circuit [350kg x 1.0m] & Libro 500 Dual Circuit [500kg x 1.5m]

For high level installation work where an overhang prevents cranes from lowering their load flush with the envelope, an overhang beam provides an ingenious way of overcoming the problem. The new dual circuit Libro 350 and Libro 500 update standard overhang beam design, offering a compact frame with further reach from suspension point to pad extension that allows glazing under overhangs with a maximum depth of 1750mm.



Technical Specifications

Vacuum system	dual circuit:	1 pump, 2 vacuum tanks	
Suitable for lifting	material properties:	gastight, other materials possible but subject to test	
	surface:	smooth or slightly structural	
	example:	glass, sheet metals and plastics	
Suction cup type	approx diameter:	300mm	
Suction cup quality	description:	black rubber, not abrasion resistant, heat resistant up to 100°C	
Number of suction cups	cups:	Libro 350	Libro 500
		8	10
Loading capacity of frame (on smooth and clean surface at 60% vacuum)	vertical:	350kg x 1m	500kg x 1.5m
	horizontal:	350kg x 1m	500kg x 1.5m
Weight of lifter	approx:	1200kg inc counterweights	1450kg inc counterweights
Depth of overhang	approx:	1000mm	1500mm
Output	approx:	1.5m ³ /h	
Balance control	control:	screw drive counterweight saddle, variable speed forward and reverse	
Voltage	pump:	12v DC from rechargeable battery	
	battery charger and mains supply:	110v/240v 50/60Hz single phase factory selectable	
Standard accessories	standard:	2 x extension arms & pads, cable remote for vacuum suction/release, cable remote for counterweight movement	
Optional accessories	optional:	reverse tilt, infrared remote for vacuum suction/release For increased overhang projects, please contact the GGR-UNIC technical team	

Libro 350 & 500



Libro 'hook-only' overhang beam allows attachment of standard lifters and flexible load movement

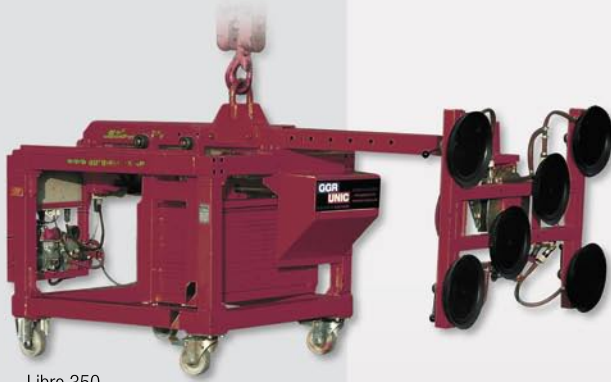

Libro 350

- Provides access to overhangs of depth 1500mm with optional expansion to 1750mm dependent on capacity
- Vacuum gauge for each circuit
- Manual +/-90° lockable rotation
- Manual tilting from vertical to horizontal in 15° increments
- Remotely controlled, low voltage, electrically-driven counterweight saddle
- Saddle overrun stop switches for safety, operates in both forward and reverse directions
- On-board maintenance-free vacuum pump powered by 12v battery with integral charger or 110v/240v mains
- Dual vacuum reserve tanks
- Audio-visual low vacuum alert



Libro 500

Dual Circuit Libro 350 • Code VOB350

Dual Circuit Libro 500 • Code VOB500

Technical Data - Libro 350

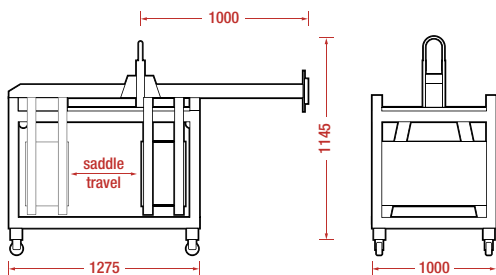

Libro 500

