

CLEO Dual Circuit [500kg] Collapsible Lift Entry Operation Robot

CLEO is a mini glazing robot with foldable lifting arm and stowable outriggers. With a width of only 600mm when folded, CLEO is designed to be easily transported in a standard passenger lift and through a standard doorway, making it ideal for reglazing situations when all structural work is complete. When in position with outriggers extended, CLEO can lift up to 500kg with a maximum working radius of 3000mm. Its robotic arm allows precise positioning and load manipulation for 'inside-out' glazing.



Technical Specifications

Vacuum system	dual circuit:	1 pump, 2 vacuum tanks
Suitable for lifting	material properties: surface: example:	gastight smooth glass, plastic boards, ceramic plates, sheet metals, coated boards, porous materials are possible but must be subjected to testing
Capacity (on smooth and clean surface at 60% vacuum)	at all jib lengths:	500kg
Length	outriggers folded: outriggers extended:	1210mm 1687mm
Width	outriggers folded: outriggers extended:	600mm 3000mm
Height	folded:	1820mm
Weight	weight:	1250kg (removable outriggers, 50kg each)
Floor loading (max load)	maximum:	4.75kN/m ²
Power requirements	Power drive and manipulation of the head and arm is powered by 110v/32A site supply. An LPG-powered generator is available for situations where site supplies are not present.	
Number of suction cups	The number of cups will vary with the task requirement. Standard size frames are available with 4, 6 or 8 cups. Custom built frames are available.	
Optional accessories	optional:	available with MRTA6 vacuum lifter

CLEO



designed to be
easily transported
in a standard passenger
lift and through
a standard doorway

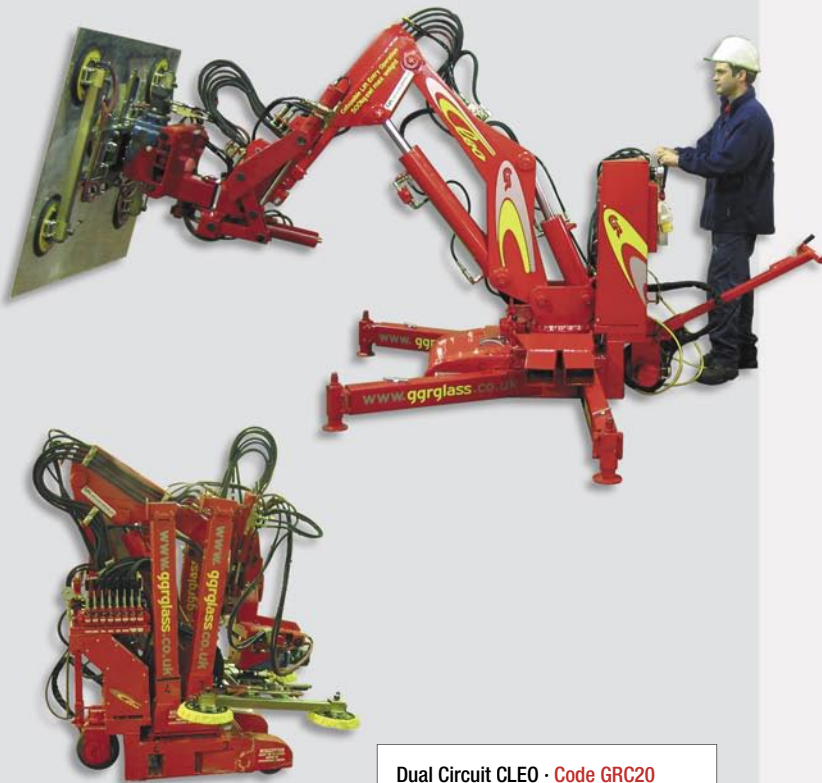

Dual Circuit CLEO · Code GRC20

- Dual, independent vacuum circuits with two vacuum reserve tanks and two non-return valves
- Vacuum gauge for each circuit
- Capacity 500kg
- Reach 4.0m from floor to pad face
- Working radius 3.0m
- Four outriggers provide stability and reduce floor loading
- Unique, patented head allows a unit to be manipulated with ease through:
 - 80° left and right of centre
 - 80° up and down from centre
 - 360° continuous rotation in either direction
 - 100mm parallel movement either side of head centre axis
- Powered by 110v/240v site supply
- On-board maintenance-free vacuum pump powered by 12v battery with integral charger or 110v/240v mains
- Audio-visual low vacuum alert

Technical Data

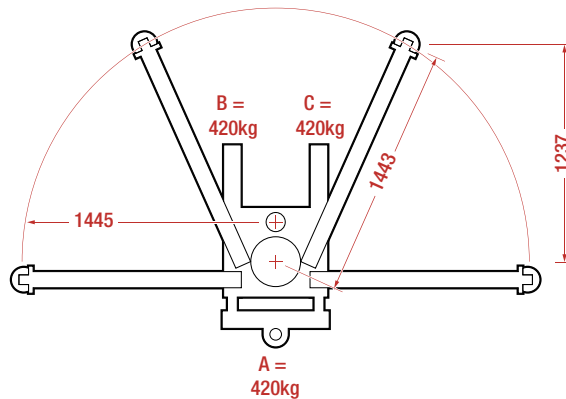
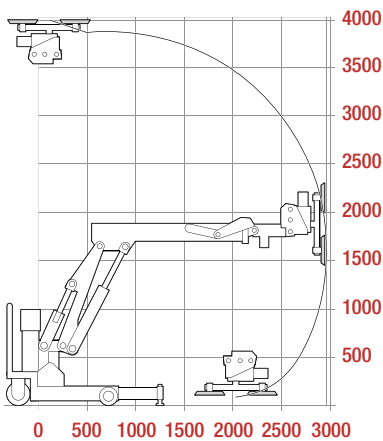
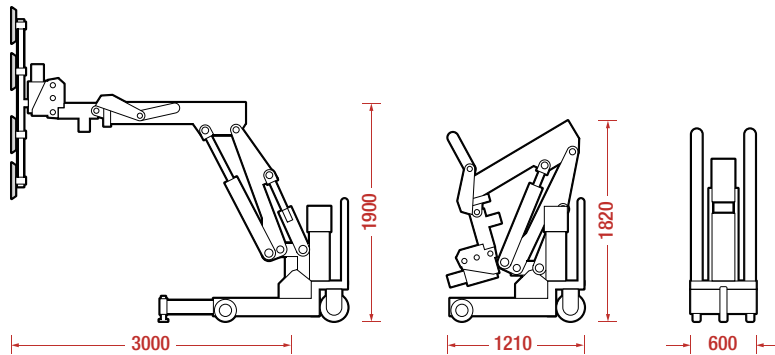

A,B,C are loadings on wheels when no load is being lifted